

Rinse Arch

0956XX / 0966XX



Hydro-Chem, Inc.
6605 Broadmoor Ave SE
Caledonia, MI 49316

Office: (616) 531-6420
e-mail: service@hcs-clean.com

Air Pressure from ACP	Approx. 90-100 PSI
Approx. Dimensions	*Varies - See Arch Cut Sheet
Internal Clearance	*Varies - See Arch Cut Sheet
Typical Arch Flow (from a 60HP Pump)	175-260 GPM

*Arch Cut Sheets contain Parts Breakdowns and other information, if necessary, that is specific to the arch

General Info

The purpose of this manual is to provide the necessary information to install and operate the Hydro-Chem equipment to exceed your defined expectation.

The Rinse Arches (OBA or BA) will come shipped as 2 leg assemblies and 1 crossbeam assembly. This are constructed and anchored on-site per the project specific MEP. If the arch oscillates, air plumbing details are also included in the project MEP or Set-Up packet.

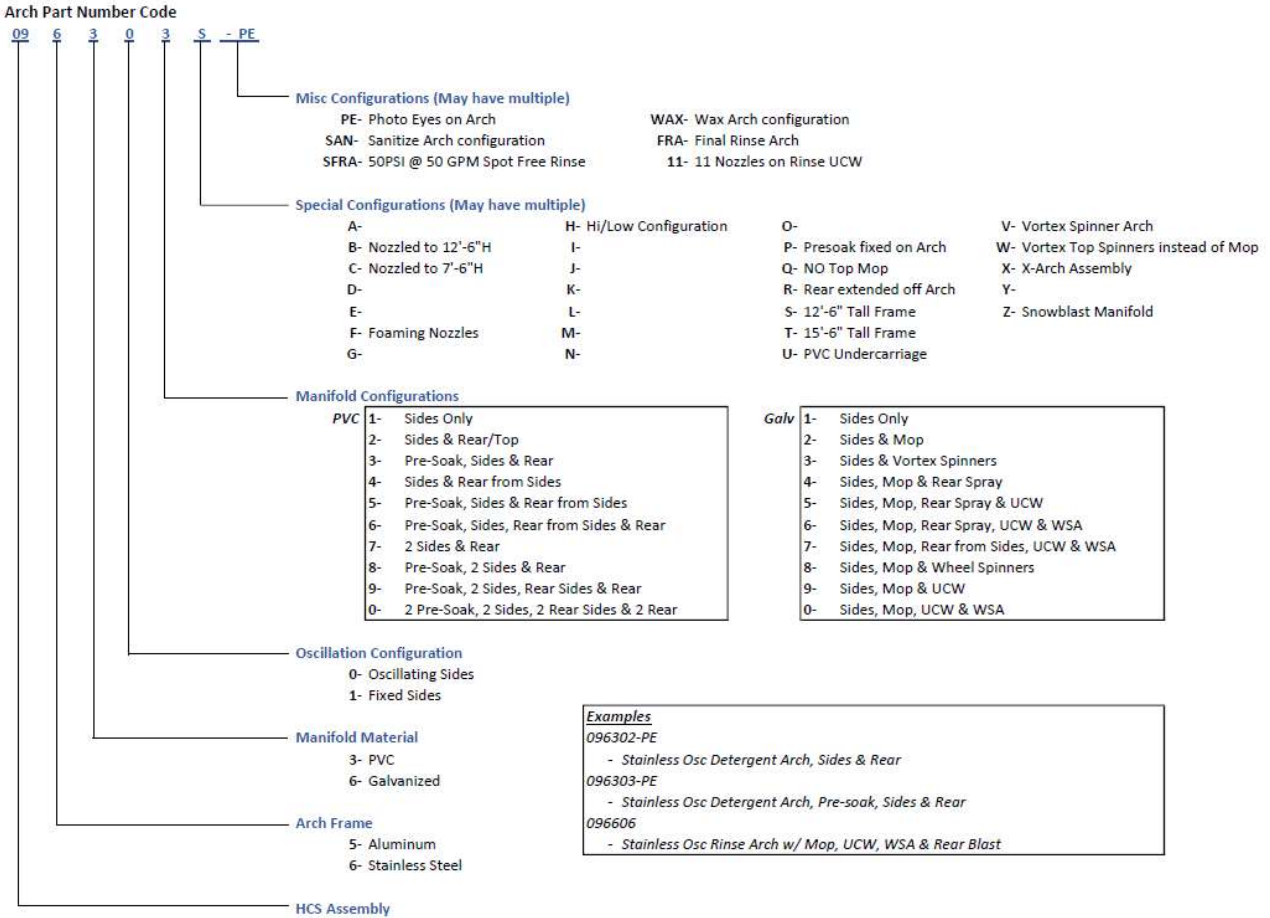

System Overview

For a full system overview, review the Cut Sheet or Parts Breakdown for the specific arch that is being used. Figure 1 breaks down the air cylinder assembly for arches that have oscillating side manifolds. The cylinders are fed from the Detergent Air Control Panels (ACP-D) at approximately 90-100 PSI.

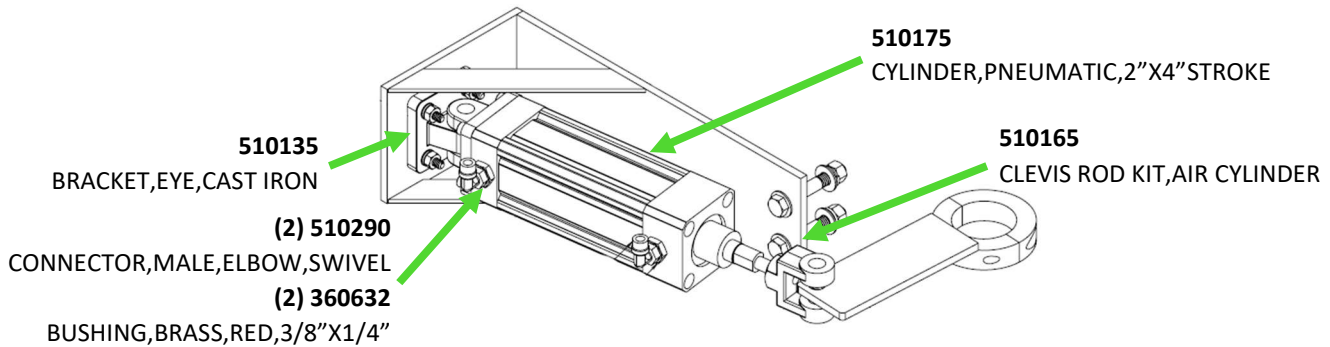

Figure 1. Air Cylinder Assembly for Oscillation

Figure 2 shows the assembly of the Wheel Spinner Assembly (WSA). These are typically fed from the side manifolds of the arch if they're included with the arch.

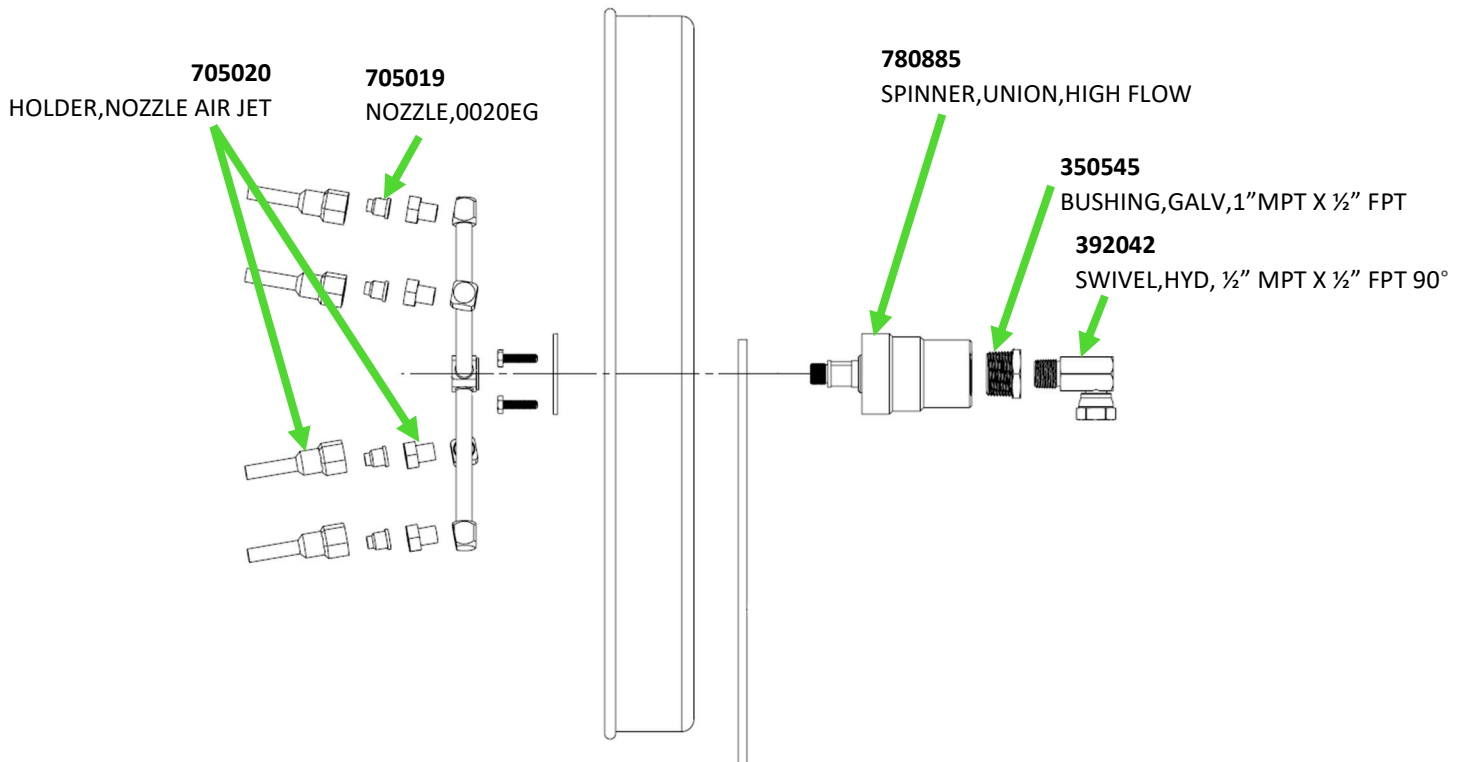

Figure 2. Wheel Spinner Assembly

Installation & Set-Up

The arch assembly is to be assembled and anchored within the wash bay per the project MEP, utilizing the supplied support legs and 3/8" hardware. Arch breakdown sheets can be found in the project Set-Up packet or Manual, providing a detailed BOM. For oscillating manifolds, review the project packets and MEP for air plumbing specifications.

When installing the arch, the detergent nozzles will come attached to their cap and must be installed on the arch per the arch breakdown sheet within the Set-Up packet. At system start-up, the ACP-D should be set at 40 PSI and fine-tuned from there. Before testing any detergent manifolds, the plugs and caps on each manifold should be removed and each line should be flushed. Once this is done, reinstall all plugs and caps on the detergent manifolds.

Maintenance

Periodically, the arches should be reviewed while running to ensure proper pressure and spray patterns. If a nozzle is "leaking", dripping, or not spraying at all, check that the nozzle is clean and free of any debris. If manifolds are not activating or oscillating as intended, review the troubleshooting table here, and if necessary, the MCP and ACP trouble shooting sections as well.

Troubleshooting

Issue	Potential Solution
Rinse arch not activating	Check that the MCP is powered on
	Check that no System Stop buttons are pushed in
	Is the Rinse Water Tank filled about the halfway mark? If it's not, make sure water is on and the fill valve(s) are working properly.
	Check that the Exit Door Open Switch is active on the Monitor System in the Touch Panel. If it's not, adjust the switch and test for proper operation.
	<p>No - Does the input that activates the manifold operate correctly (Loop or Photo Eye) and is it activating on the Touch Panel?</p> <p>Yes - Check programming and the Output on the PLC - Although unusual, an output could be burnt.</p> <p>No - If it is a Photo Eye, ensure they are aligned and that their signal light is activating when blocked. If it is a Loop, check if the Loop Detector shows a fault - if not then check wires from the loop for continuity.</p>
Manifolds not oscillating during a wash	Does the Rinse Pump activate properly in Test Mode on the Touch Panel?
	<p>Yes - Check programming and the Output on the PLC - Although unusual, an output could be burnt.</p> <p>No - Check if the Rinse Pump Motor Starter has an overload tripped. If so, reset it and check amp draw. If not, check programming and the Output on the PLC.</p>
Manifolds are oscillating too slow	Are other outputs such as the Rinse Pump turning on?
	<p>Yes - Ensure that the solenoid is receiving a signal from the MCP and that it has 24VAC being supplied to it. If so, replace the solenoid on the valve.</p> <p>No - Check that no system stop buttons are pushed in. If they aren't, ensure that no breakers are tripped within the MCP and that there is 24VAC available in the panel where it should be.</p>
	<p>Check that fluid has not built up in the filter bowl. This should be drained.</p> <p>Increase the pressure on the regulator to that arch. This is done by pulling the adjustment knob upwards until you hear a click. Turn clockwise to increase pressure or counterclockwise to decrease the pressure. Once the desired pressure is obtained, push the adjustment knob down until you hear the click to secure it.</p> <p>If the pressure is already optimal, the oscillating sweep timer in the PLC program may be adjusted.</p>